

# MARINE AGM DUAL PURPOSE BATTERY

LPM12-240M (12V240Ah)



## CHARACTERISTICS

Item	Specifications	
Nominal Voltage	12V	
Nominal Capacity (20HR)	240Ah	
Reserve Capacity	525min	
Cold Cranking Amps@0°F (-18°C)	1300A	
Dimension	Length	518mm (20.4inches)
	Width	274mm (10.8inches)
	Height	235mm (9.25inches)
Approx Weight	66.5kg (146.6lbs)	
Terminal	5	
Cell layout	3	
Hold-Down	B0	
Case	Black-PP Material	
Cover	Black-PP Material	
Handle	TS8	

## APPLICATIONS

- MARINE and RV
- Start and deep cycle

## GENERAL FEATURES

- Superior starting and cycling performance
- High capacity and high CCA
- 2x faster charge acceptance than conventional starter batteries
- 3x higher cycle life than conventional starter batteries
- Advanced Absorbed Glass Mat (AGM) technology

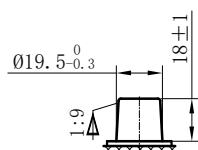

POS

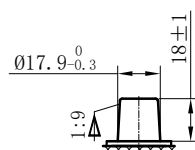

NEG

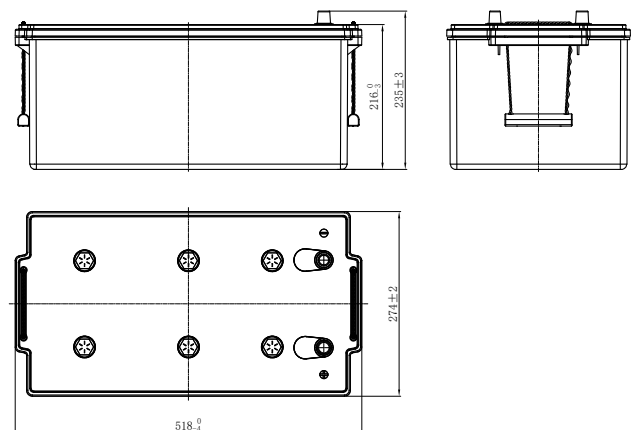

\*Values are subject to variation of +/- 5% in normal manufacturing processes.

Leoch International Technology Ltd.  
www.leoch.com

Leoch Batteries Pte Ltd  
www.leoch.sg

Leoch Battery Corporation  
www.leochamericas.com

Leoch Europe S.A.  
www.leoch.eu